

Box: PLOCK 1 Estimated Fitting Time: 1 Hour

BIKE	Yamaha MT-10	PART NO.	RYA-102
YEAR	2016 - Current	FIT KITS	Z039.10587
NOTES	Where not supplied use original fittings. We recommend to use clear silicone when fitting this product.	FEATURES	N/A

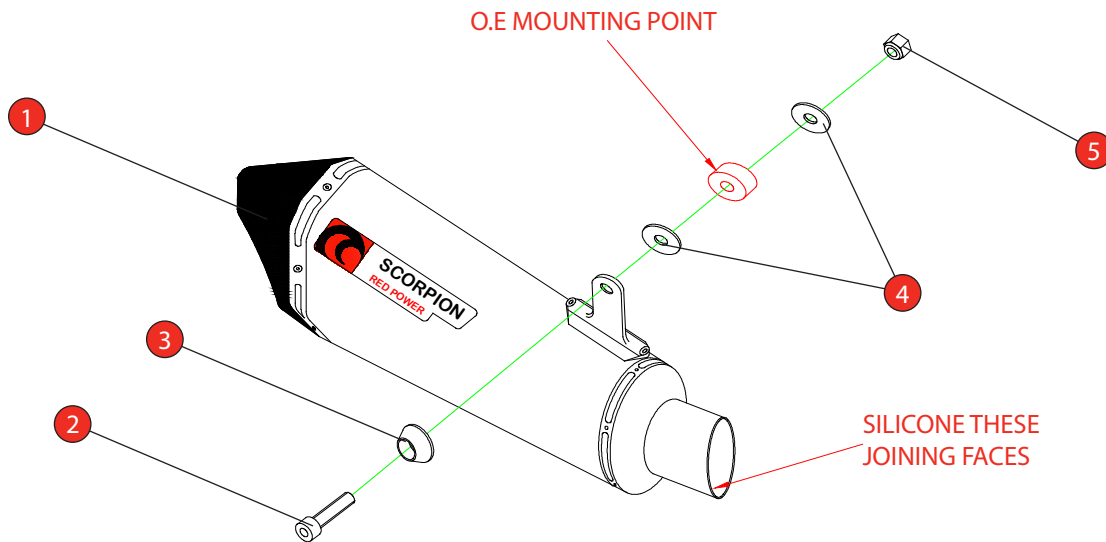

- | | |
|--|-------------------------------------|
| 1 Serket Taper Silenecer (RSC373) | 4 2 x M8 x 25mm Washer (Z017.10825) |
| 2 M8 x 40mm Cap Head Bolt (Z017.10076) | 5 M8 Nyloc Nut (Z017.10062) |
| 3 Alloy Bolt Finisher (Z026.20068) | |

NOTE: ENSURE SCORPION SYSTEM IS CLEAR OF MOVING PARTS AND ALL ORIGINAL FUNCTIONS WORK CORRECTLY.

E-MARK	e11 0955
ISSUE NO.	0
DATE	19/07/16
AUTHORISED	M.YDLIBI
CHECKED	



A) Remove original exhaust from bike, taking care to keep all original components in a safe place.

B) Refit Scorpion exhaust as per line diagram above. Ensure that the heat shield if fitted last.

C) When fitted take bike for a short ride to ensure all functions are correct.

D) When bike & exhaust are cool enough check all nuts and bolts are still secure.

Cleaning instruction overleaf:

Box: PLOCK 1

BIKE	Yamaha MT-10	PART NO.	RYA-102
YEAR	2016 - Current	FIT KITS	Z039.10587
NOTES	Where not supplied use original fittings. We recomend to use cleat silocone when fitting this product.	FEATURES	N/A

Thank you for purchasing your Scorpion Silencer.

Care of your exhaust: Please refrain from cleaning silencer with heavy solvents or abrasives!

Vielen Dank Fur den kauf eines Scorpion Schalldampfers! Pflegehinweis: Bitte verwenden Sie niemals Scheuermittel oder aggressive Reiniger zur Pflege Ihres Auspuffes!

Merci d'avoir choisi un echappement Scorpion.

Entretien de votre silencieux: Ne pas utiliser de solvants ou de produits abrasifs!

"Muchas gracias por adquirir un Silencioso Scorpion. Le recomendamos no limpiar el silencioso con productos abrasivos o aquellos que contengan disolventes."